

Door blank with Chen-Chen veneer - 55 mm stiles and rails

Construction: 1,5 mm Chen-Chen veneer
 1,5 mm cross grain veneer
 1,5 mm long grain veneer
 0,3 mm Aluminium - moisture barrier - stabilizer
 1,5 mm long grain inner veneer
 Insulation - Polystyrene (Appr. 20 kg/m³ - heat conductivity: 0,034 W/mK)
 1,5 mm long grain inner veneer
 0,3 mm Aluminium - moisture barrier - stabilizer
 1,5 mm long grain veneer
 1,5 mm cross grain veneer
 1,5 mm Chen-Chen veneer

U-Value:

U-Value - W/m ² K								
44 mm	54 mm	58 mm	60 mm	64 mm	68 mm	73 mm	80 mm	88 mm
1,02	0,84	0,78	0,76	0,73	0,68	0,65	0,60	0,56

Size 1000 mm x 2000 mm
 Heat conductivity is calculated on the basis of the practical heat conductivity of each included material - taken from data sheets and DS418, version 6, 2002. Also relating to EN 12524.

Weight:

Weight appr. Kg./m ²								
44 mm	54 mm	58 mm	60 mm	64 mm	68 mm	73 mm	80 mm	88 mm
11,0	12,0	12,4	12,6	13,0	13,4	13,9	14,7	15,5

Size 1000 mm x 2000 mm

Measure:

Min.: 250 x 450 mm - Max.: 1200 x 2400 mm

Tolerances:

Width/Height: +/- 1 mm - Diagonal: +/- 2 mm - Thickness: +/- 0,8 mm

Section drawing:

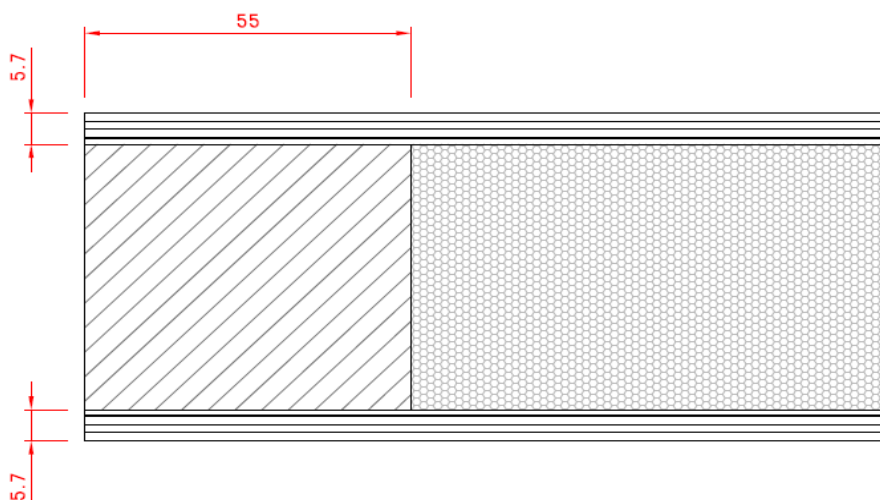

O.H.Industri A/S
 Smedevej 17
 DK - 7430 Ikast
 +45 9725 1200
www.ohindustri.com

Made: 05.03.14	Data sheet: PMN	Draw.: HMN
Revised:	Data sheet:	Draw.: